

6-Speed Remote Controller Operating Instruction

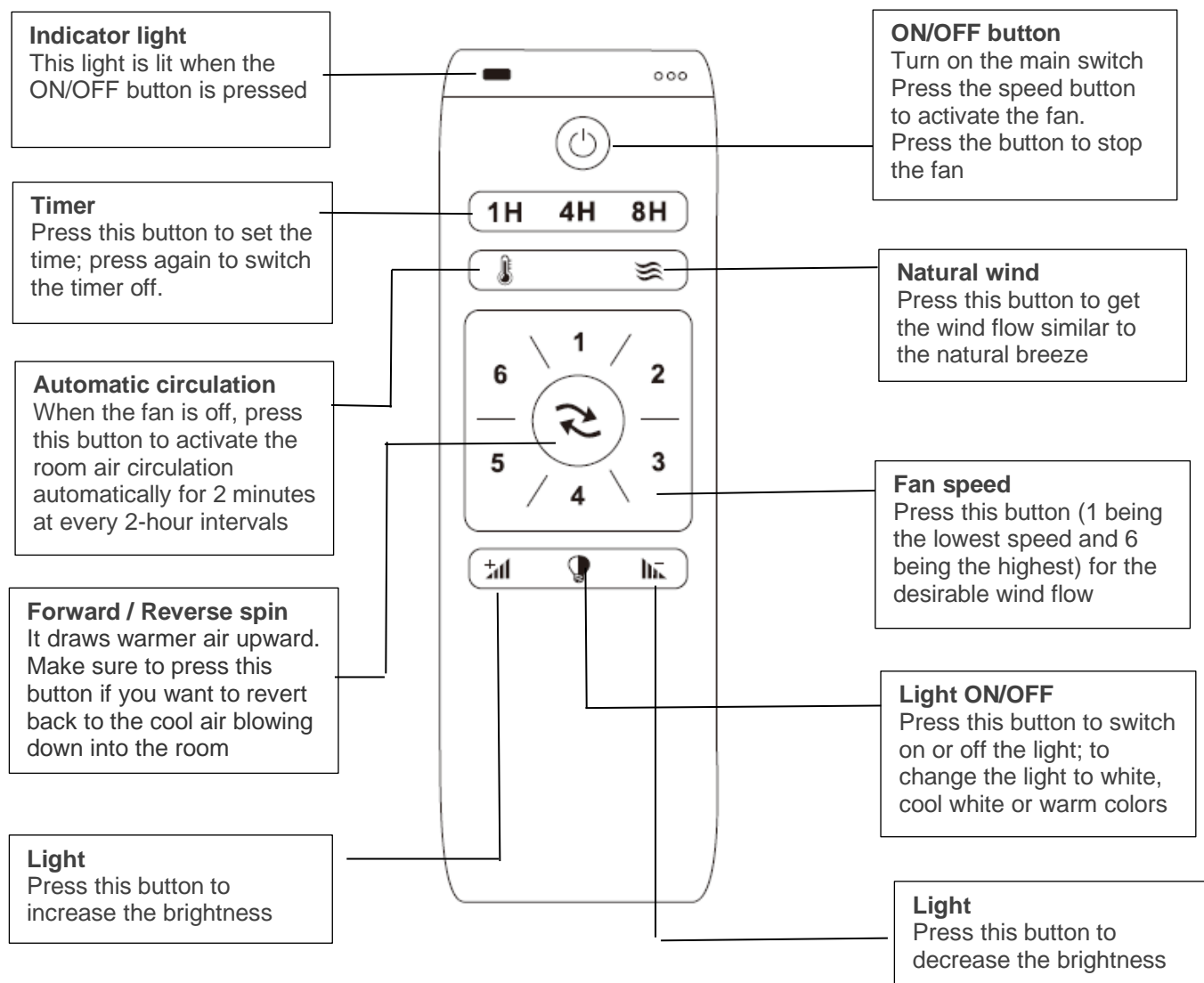

The fan needs to be paired with the remote controller when first time use

1. Turn on the main power switch
2. Press and hold the ON / OFF button till you have heard 2 beeping sounds

Re-pairing

1. If the main power was cut off due to short circuit or other situations, then the pairing should be repeated
2. Turn off the power supply, wait for 20 - 30 seconds, and then turn on the electricity and repeat the pairing
3. Press and hold the ON / OFF button till you have heard 2 beeping sounds